

# BASE OR LOWER CABINET

## ARE YOU CHOOSING THE CORRECT SIZE?

MAKE SURE TO CORRECTLY MEASURE YOUR CABINET'S OPENING (INSIDE DIMENSIONS)

- Measure side to side (width)
- Measure front to back (depth or length)
- Measure top to bottom (height)

DOUBLE CHECK THAT THE PRODUCT IS WITHIN YOUR MEASUREMENTS AND DON'T FORGET TO TAKE INTO ACCOUNT ANY OBSTRUCTIONS (PLUMBING, HINGES, ETC.)

### FULL ACCESS (Frameless)

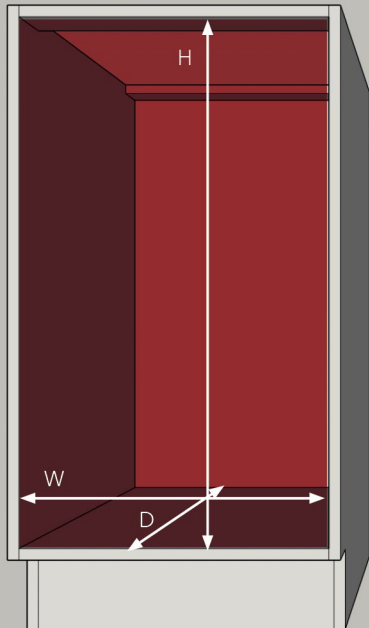

### FACE FRAME

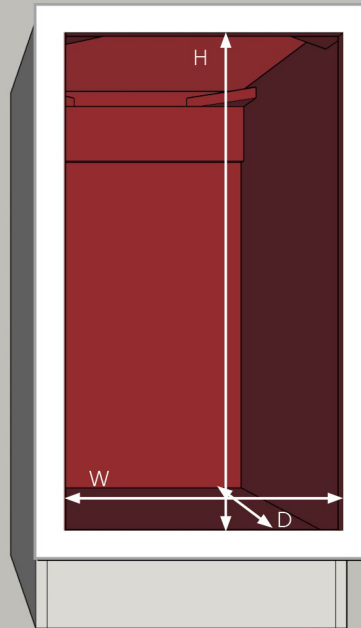

Types of  
face frames:

1-1/2"  
1-3/8"  
1-3/4"  
and Inset

Rev-A-Shelf manufactures products that install into nearly all cabinet sizes. Make sure to correctly measure your cabinets to allow the best fit.